

VITE A TESTA ESAGONALE

Viti testa esagonale tutto filetto, passo grosso UNC

DIN 933 UNC/UNF

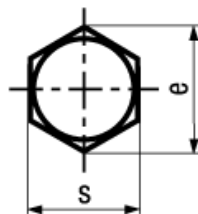

Materiale

Acciaio Inox:
A2-70; A4-70
Acciaio Classe:
8.8

Rivestimento

Naturale
Zincato Bianco
Zincato Giallo

d	#4	#5	#6	#8	#10	#12	1/4	5/16	3/8	7/16	1/2	9/16	5/8	3/4	7/8	1
UNC	4-40	5-40	6-40	8-32	10-24	12-24	20	18	16	14	13	12	11	10	9	8
UNF	4-48	5-44	6-40	8-36	10-32	12-28	28	24	24	20	20	18	18	16	14	12
s	4,77	4,77	6,35	6,35	7,92	7,92	11,12	12,07	14,27	15,87	19,05	20,62	23,82	28,57	33,32	38,10
k	4,52	1,78	2,36	2,79	3,04	3,93	4,77	5,96	6,80	8,02	9,24	9,42	11,27	13,31	15,34	17,78